



MARIANO MARCOS STATE UNIVERSITY

Bids and Awards Committee

INVITATION TO MAKE AN OFFER: Negotiated Procurement

21-016-4

THE PROJECT: Provision of Glass and Aluminum Partitions at ITC and Server Room, Flexible Learning Hub

Number of Working Days: 10 calendar days
ABC: P196,280.44

1. The Mariano Marcos State University (MMSU), with offices at Quiling Sur, City of Batac, Ilocos Norte, invites the public to make an offer to furnish all labor, materials, tools and equipment necessary and proper for the implementation of the above Project as per approved designs, plans and drawings.
2. This process is in accordance with Section 53 of R.A. 9184, the Government Procurement reform Act and Section 53.9 of the Implementing Rules and Regulations where interested and qualified contractors are to submit proposals.
4. The offer must be in writing submitted at the address below on or before **November 24, 2021; 2:00 PM** together with the following documents:
 - a) The amount of the offer in writing duly signed by the person making the offer, indicated in numbers and figures.
 - b) The particulars of the offer as to labor, materials, tools, equipment and other work details.
 - c) Documents in support of the legal, technical and financial capability of the person making the offer, which documents shall be confirmed and verified (3 copies).
5. It is understood that any offer may be accepted or rejected, or the process invalidated, at any time prior to contract award, without liability to anyone.
6. Documents for this procurement may be secured from the MMSU BAC Secretariat at the address below or downloaded from the MMSU website or from the Philippine Government Electronic Procurement System (PhilGEPS) website.
7. For questions and inquiries, please write or email the University President, thru the BAC Chair, at the address indicated below.

Mariano Marcos State University
Quiling Sur, City of Batac
www.mmsu.edu.ph

November 19, 2021

NATHANIEL R. ALIBUYOG
BAC CHAIR

Received: _____ Received: _____

Rm105 FEM Hall, MMSU, #16S Quiling Sur, City of Batac, Ilocos Norte
✉ bac@mmsu.edu.ph ☎ (077) 600-0459 www.mmsu.edu.ph

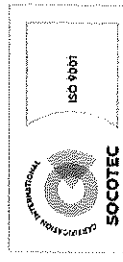

Republic of the Philippines
MARIANO MARCOS STATE UNIVERSITY
City of Batac, Ilocos Norte

PROJECT INFORMATION DOCUMENT

Project Title : Provision of Glass and Aluminum Partitions at ITC and Server Room, Flexible Learning Hub
Project Location : 2nd Flr. Main Library, MMSU-Batac City, Ilocos Norte

The project calls for the furnishing of all materials, labor, tools and equipment needed for the Provision of Glass and Aluminum Partitions at ITC and Server Room, Flexible Learning Hub, 2nd Flr. Main Library, MMSU- Batac City, Ilocos Norte. The project shall be executed in strict conformity with the designs, plans, drawings and other details, as well as the Specifications, this Project Information Document and other related contract documents prepared and approved for this project.

It also calls for the employment of manpower with the appropriate skills and expertise to undertake the specific items of work and to enable the contractor to produce and deliver to the satisfaction of the owner the needed services and output required of this undertaking. In addition, the Contractor shall have adequate and readily available construction tools and equipment to be utilized during the construction activities of the project. It is also necessary that the **Contractor shall have regularly at the site a qualified Project Engineer to administer strictly the implementation of the project, including maintaining a logbook of construction activities, as well as receiving authorized University Officials and Inspectors.**

General Instructions

Specifically, the project covers the Provision of Glass and Aluminum Partitions at ITC and Server Room, Flexible Learning Second Floor, CRL Bldg.. The Bidder/Contractor is advised to check the area where aluminum and glass partitions and glass are to be provided, prior to preparation of estimates. The Contractor shall ensure that the construction activities shall not interfere, obstruct and disturb any on-going operation of the other areas and facilities in the ITC and Server Room and the adjoining areas, hence, the Contractor shall construct a temporary enclosure if needed to enclose and isolate the working area from the other spaces and facilities in the area. In addition, the Contractor shall be required to provide its own water(if necessary) and coordinate properly with the Owner the needed power supply system in the proper execution of the various works for the duration of the contract.

The prospective bidders shall submit a bid proposal for the abovementioned project with the following scope of works:

1. **Roughing in Works.**
This include clearing, removal of existing materials and cleaning of the affected area/s prior and after the project is completed, including necessary safety program for the project;
2. **Glass and Aluminum Partitions**
This item shall consist of furnishing all the materials, hardware, tools, labor and services necessary for the fabrication, delivery and installation of analog aluminum partitions and clear glass with frosted sticker at the Server area of the required type and size as shown in the

Schedule of Doors and Partitions, in the Specifications and Bill of Quantities and as approved for this project. The Contractor shall install the partitions in such a way that aluminium with glass partitions are properly mounted on the existing aluminium and glass partitions. The Contractor is advised to show sample of all materials to be installed for approval prior to purchase and fabrication.

3. Glass partitions at Lattice Area

This item includes provision of ¼" thick clear glass on the existing wood latticed partition on the upper level of entrance wall to the ITC area. The Contractor shall install the glass panels, properly fixed on the existing latticed wall, with necessary accessories/sealant for proper mounting and sealing.

Supplementary Provisions

All items or scope of works not mentioned in this document but shown and/or indicated in the plans, drawings and specifications, except where it is specifically mentioned as "to be provided by others", the Contractor shall likewise furnish all materials, labor and equipment necessary to complete the same.

In case that a conflict arises in the specifications and quality of materials, installation procedure and in the plans and drawings as well as in the other contract documents before and during the implementation stage., the same should be referred to the end-user, for proper resolution of the said conflict.

After all the work have been completed, the surrounding immediate areas affected in the execution of the project shall be cleaned and cleared of all excess materials and debris, temporary structures and facilities and utilities used during the construction period. All spillage and scattered materials caused by the activities undertaken in the area, as well as markings and signage shall likewise be removed to the full satisfaction of the Owner.

A. TIME is a very important factor in the implementation of the project and such, all works indicated in the plans, specifications and in the document shall be fully completed within **Ten (10) Calendar Days** from receipt of the Notice to Proceed.

B. The Approved Budget for the Project to be Bid is **One Hundred Ninety Six Thousand Two Hundred Eighty Pesos and Forty Four Centavos(P 196,280.44)**

Prepared By;

AIDA V. CABANG
Architect, PPDO

Checked By:

ROMEO B. BULDULAO
Director, PPDO

Republic of the Philippines
MARIANO MARCOS STATE UNIVERSITY
City of Batac, Ilocos Norte

SPECIFICATIONS

Project Title : Provision of Glass and Aluminum Partitions at ITC and Server Room, Flexible Learning Hub

Project Location : 2nd Flr. Main Library Bldg. MMSU-Batac City, Ilocos Norte

Item No.	Description
I.	<p><u>Roughing Works</u></p> <p>Cleaning and Clearing Health and Safety Requirements Temporary Security and Enclosure</p>
II.	<p><u>Glass and Aluminum Partitions</u></p> <p>a. Glass Partition C 6 mm. thk. clear fixed glass on analok aluminium frame, with frosted sticker</p> <p>b. Glass Partition D 6 mm. thk. clear fixed glass on analok aluminium frame, with frosted sticker</p> <p>c. Glass Partition B 6 mm. thk. clear fixed glass on analok aluminium frame, with frosted sticker</p>
III.	<p><u>Glass partitions at Lattice Area</u></p> <p>6 mm. thk. clear fixed glass properly mounted and fixed at the existing lattice wall</p>

Prepared By:

AIDA V. CABANG
Architect, PPDO

Recommend Approval:

ROMEO R. DULDULAO
Director, PPDO

Republic of the Philippines
MARIANO MARCOS STATE UNIVERSITY
City of Batac, Ilocos Norte

BILL OF QUANTITIES

Project Title : Provision of Aluminum and Glass Doors and Partitions at ITC and Server Room, Flexible Learning Hub

Project Location : 2nd Flr. Main Library Bldg. MMSU-Batac City, Ilocos Norte

Item No.	Description	Quantity	Unit
1.0	<u>Roughing Works</u> Occupational Safety and Health Program Mobilization and Demobilization Photodocumentation	1	lot
2.0	<u>Glass and Aluminum Partitions(Partitions above existing alum. Partitions at ITC and Server Rooms</u> a. Glass Partition C- 6 mm. thk. clear fixed glass on analok aluminium frame, with frosted sticker b. Glass Partition D 6 mm. thk. clear fixed glass on analok aluminium frame, with frosted sticker c. Glass Partition B 6 mm. thk. clear fixed glass on analok aluminium frame, with frosted sticker	17.21	sq. m.
3.0	<u>Glass Partitions at Lattice Area</u> 6 mm thk clear fixed glass	17.21	sq. m.
		7.71	sq. m.
		27.26	sq. m.

Prepared By;

AIDA V. CABANG
Architect, PPDO

Recommend Approval:

ROMEO R. DULALAO
Director, PPDO

BREAKDOWN OF ESTIMATED EXPENDITURES	% OF TOTAL	AMOUNT
I. ESTIMATED DIRECT COST A. DIRECT COST 1. Materials 1.1. Supply Delivery 2. Labor (Including Fringe Benefits) 3. Equipment Expenses 3.1. Rentals 3.2. Mobilization/Demobilization, (1% of A1 - A3) B. INDIRECT COST 1. Overhead, Contingencies and Miscellaneous (12% of A1 - A3) 2. Contractors Profit, (8% of A) 3. VAT, (5% of A1 - A3)		
Sub-Total (By Contract)		0.00
II. ESTIMATED GOVERNMENT EXPENDITURES A. Engineering and Administrative Overhead 1 to 1.5% of the Appropriation of the Project B. Quality Control C. Road Right of Way/Acquisition D. Preliminary Detailed Engineering		
Sub-Total	0	0
III. CONTINGENCIES AND PROJECT REVERSES A. Physical Contingency B. Price Escalation		
Sub-Total	0	0
TOTAL ESTIMATED PROJECT COST	0.00%	0.00
Prepared by:	Reviewed / Checked by:	Conforms:
	Recommend Approval:	
	Funds Available:	APPROVED:

Item No. I.	Quantity: 1
Description: Roughing In Works	lot

	Description	Quantity	Unit	Unit Price	Sub-Total
MATERIALS COST	Total Materials Cost			Sub-Total	-
				Unit Cost	
				Unit Price	Sub-Total
EQUIPMENT COST	Total Equipment Cost			Sub-Total	-
				Unit Cost	
				Unit Price	Sub-Total
LABOR COST	Description	Quantity	Unit	Unit Price	Sub-Total
	Clearing and Cleaning the area Skilled Laborers		days		-
	Total Labor Cost			Sub-Total	-
				Unit Cost	

DIRECT COST: -
DIRECT UNIT COST: -

Plus Indirect Cost:
OCM -
CP -
VAT -

Indirect Unit Cost: -

Total Direct and Indirect Cost: -

Item No.: III.	Quantity: 1
Description: Glass Partitions at Lattice Area	lot

	Description	Quantity	Unit	Unit Price	Sub-Total
MATERIAL COST	2.00 m. x 1.13 m. - 6 mm. thk. Clear Glass (2.26 sq.m each)		sets		-
	1.75 m. x 1.13 m. - 6 mm. thk. Clear Glass(1.98 sq.m each)		sets		-
	1.00 m. x 0.60 m. - 6 mm. thk. Clear Glass(0.60 sq.m each)		sets		-
	Include Materials , Delivery and Installation . Supplier to check exact dimension of latticed window where glass will be installed				
	Total Materials Cost			Sub-Total	-
				Unit Cost	
EQUIPMENT COST		Quantity	Unit	Unit Price	Sub-Total
	Total Equipment Cost			Sub-Total	-
				Unit Cost	
LABOR COST		Quantity	Unit	Unit Price	Sub-Total
	Total Labor Cost			Sub-Total	-
				Unit Cost	

DIRECT COST: -
DIRECT UNIT COST: -

Plus Indirect Cost:
OCM -
CP -
VAT -
Indirect Unit Cost: -



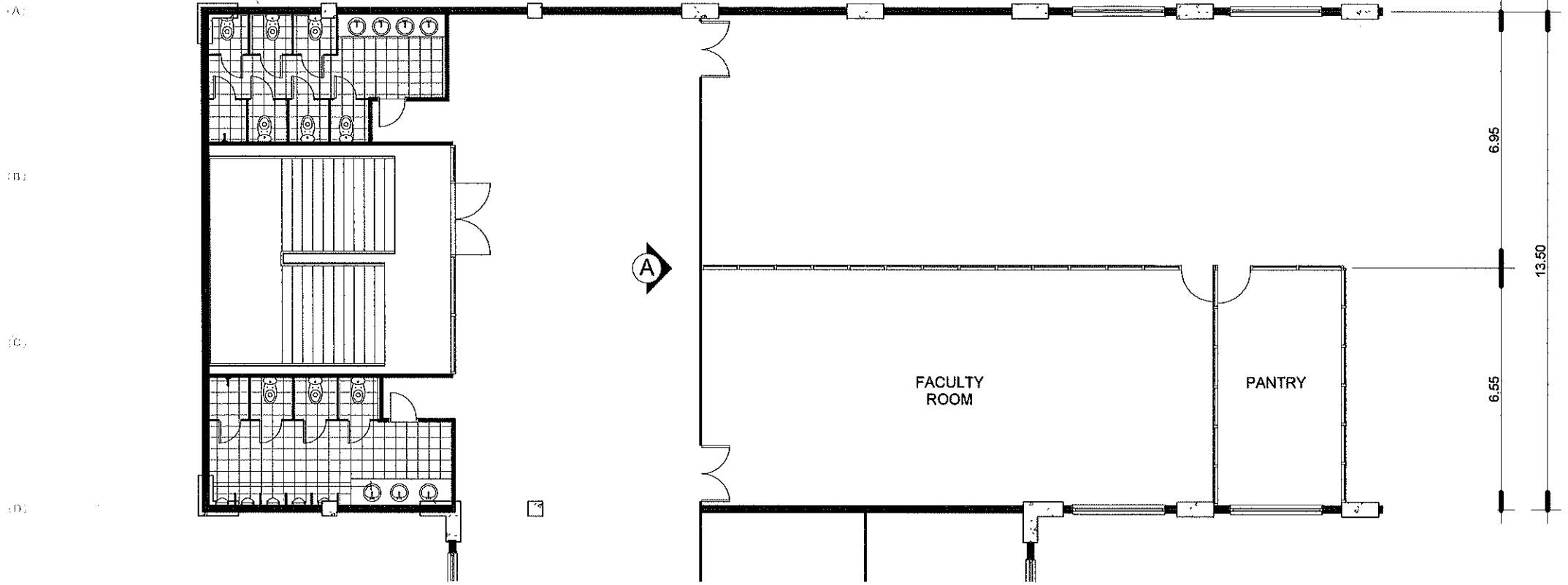

Total Direct and Indirect Cost: -

(19) (20) (21) (22) (23) (24) (25) (26) (27)



① PARTIAL FLOOR PLAN OF MAIN LIBRARY
1 : 150 MTS



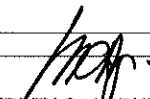

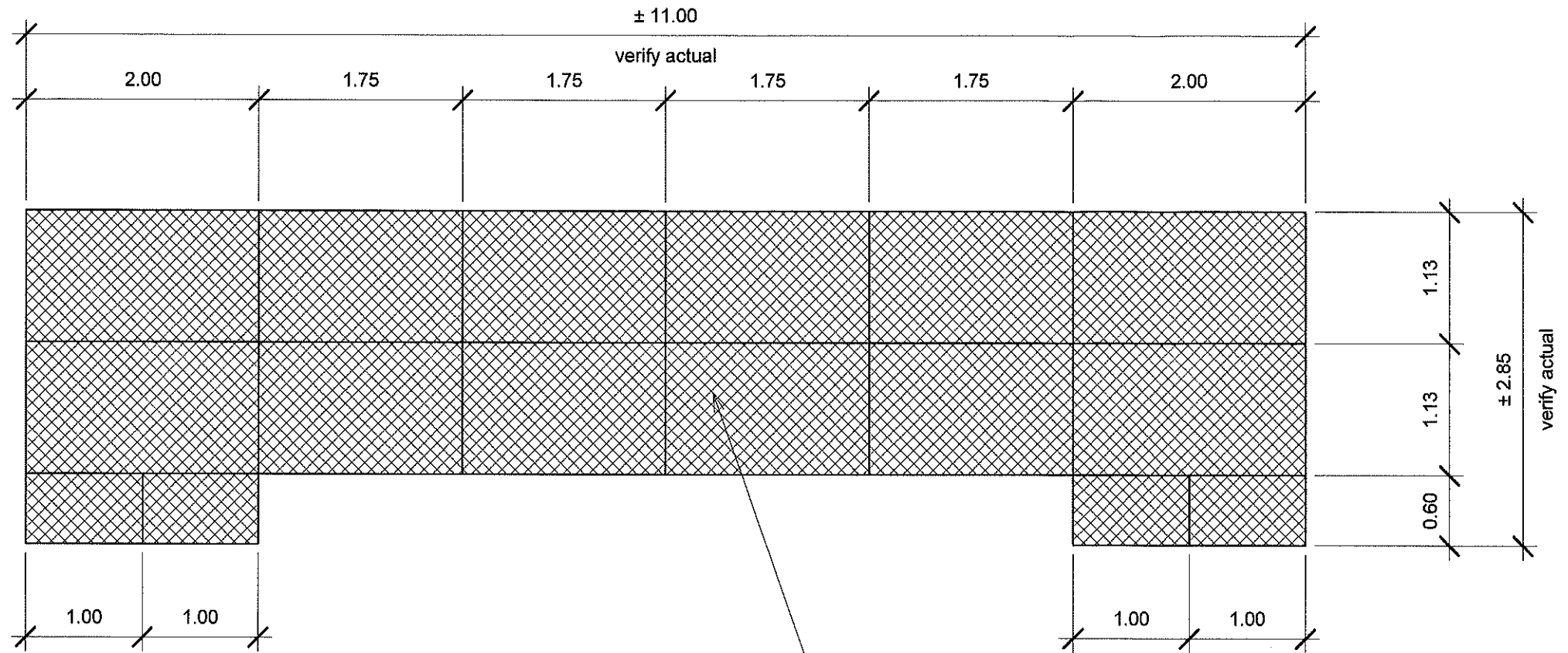
NOTE: PROVISION OF GLASS WALLS / PARTITIONS ONLY. CONTRACTOR TO CHECK ACTUAL PRIOR TO COSTING / ESTIMATES.

	DRAWN BY: BJAY R. DAYANG DRAFTSMAN I	PROJECT TITLE: PROVISION OF GLASS AND ALUMINUM PARTITIONS AT ITC AND SERVER ROOM	CONFORME:  SATURNINA NISPEROS DIRECTOR, INFORMATION TECHNOLOGY CENTER	SHEET CONTENT: PARTIAL FLOOR PLAN OF MAIN LIBRARY	SHEET NO.:
	PREPARED BY:  AIDA V. CABANG ARCHITECT IV	LOCATION: MMSU - MAIN LIBRARY, CITY OF BATAV, ILOCOS NORTE	CHECKED/REVIEWED BY:  AIDA V. CABANG CHIEF - PHYSICAL PLANNING SECTION	RECOMMENDING APPROVAL:  ROMEO ADUL DULAO CHIEF, ITC	APPROVED BY:  SHIRLEY C. ABRUPIS UNIVERSITY PRESIDENT





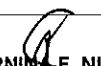

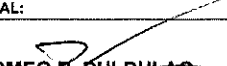
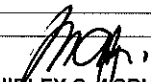
1/4" THK. CLEAR GLASS TO BE PLACED ON LATTICED WALL

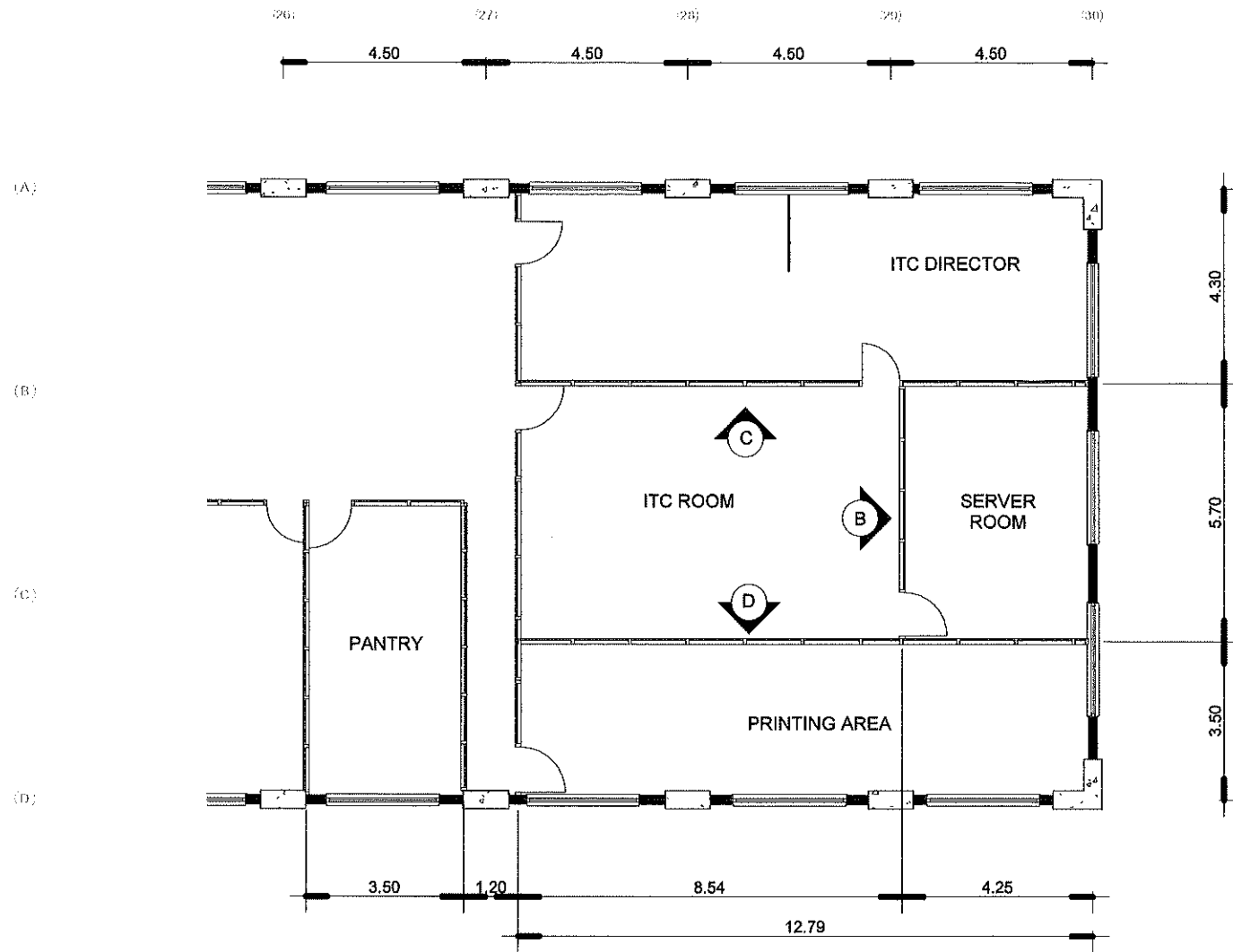
CLEAR GLASS ON LATTICED "A"

	DRAWN BY:  BJAY DAYANG DRAFTSMAN I	PROJECT TITLE: PROVISION OF GLASS AND ALUMINUM PARTITIONS AT ITC AND SERVER ROOM	CONFORME:  SATURNINA E. NISPEROS DIRECTOR, INFORMATION TECHNOLOGY CENTER	SHEET CONTENT: CLEAR GLASS ON LATTICE	SHEET NO.:
	PREPARED BY:  AIDA V. CABANG ARCHITECT IV	LOCATION: MMSU - MAIN LIBRARY, CITY OF BATAV, ILOCOS NORTE CHECKED/REVIEWED BY:  AIDA V. CABANG CHIEF - PHYSICAL PLANNING SECTION	RECOMMENDING APPROVAL:  ROMEO R. BULBULAO DIRECTOR, PPDO	APPROVED BY:  SHIRLEY C. AGRUPIS UNIVERSITY PRESIDENT	

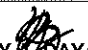

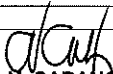
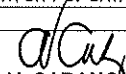
① PARTIAL FLOOR PLAN OF MAIN LIBRARY
1 : 150 MTS

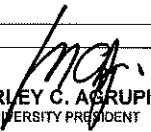
	DRAWN BY:  BJAY V. CABANG DRAFTER/SMAN I	PROJECT TITLE: PROVISION OF GLASS AND ALUMINUM PARTITIONS AT ITC AND SERVER ROOM	CONFORME:  SATURNINA F. NISPEROS DIRECTOR, INFORMATION TECHNOLOGY CENTER	SHEET CONTENT: PARTIAL FLOOR PLAN OF MAIN LIBRARY	SHEET NO.:
	PREPARED BY:  AIDA V. CABANG ARCHITECT IV	CHECKED/REVIEWED BY:  AIDA V. CABANG CHIEF - PHYSICAL PLANNING SECTION	RECOMMENDING APPROVAL:  ROMEO R. DULDULAO DIRECTOR, PPDO	APPROVED BY:  SHIRLEY C. AGRUPIS UNIVERSITY PRESIDENT	

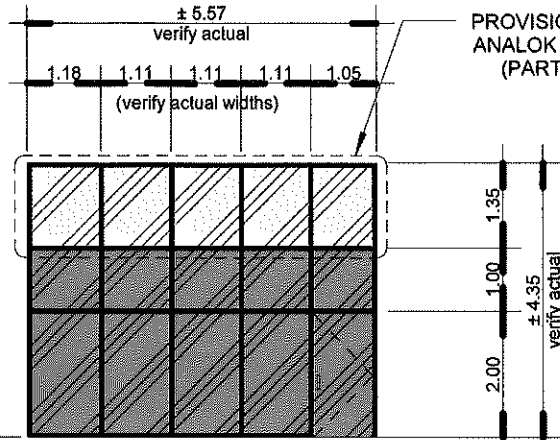

GLASS PARTITION "B"

PROVISION OF 1/4" THK CLEAR GLASS ON ANALOK FRAME WITH FROSTED STICKER (PARTITION ABOVE EXISTING ALUM. GLASS & PARTITION)

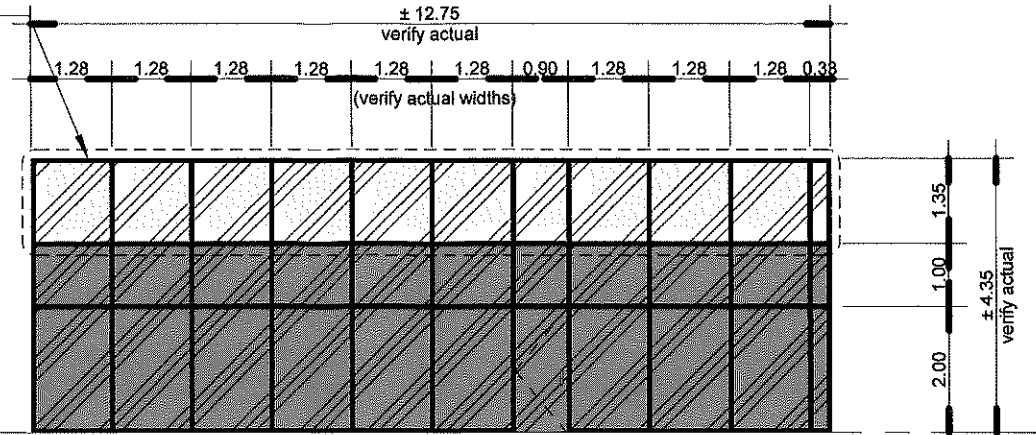

GLASS PARTITION "C"

PROVISION OF 1/4" THK CLEAR GLASS ON ANALOK FRAME WITH FROSTED STICKER (PARTITION ABOVE EXISTING ALUM. GLASS & PARTITION)

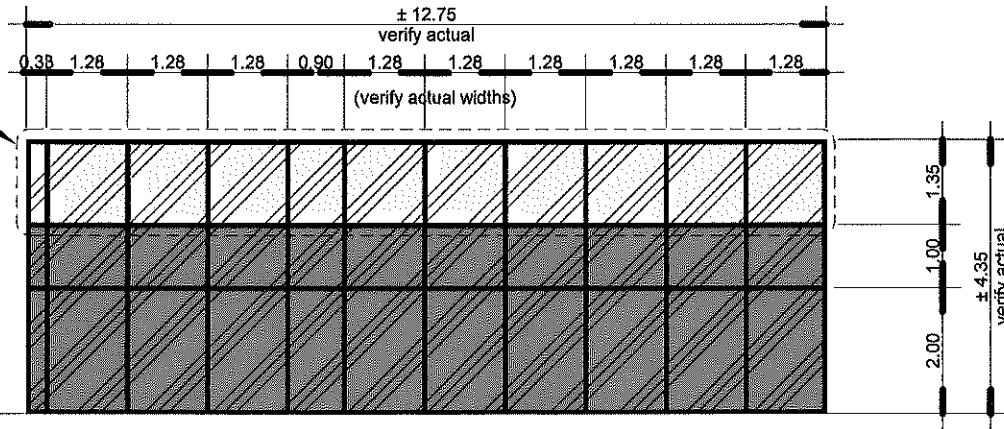

GLASS PARTITION "D"

① GLASS PARTITION DETAILS
1 : 120 MTS

	DRAWN BY:	PROJECT TITLE:	CONFORME:	SHEET CONTENT:	SHEET NO.:
	BJAY DAYANG DRAFTSMAN I	PROVISION OF GLASS AND ALUMINUM PARTITIONS AT ITC AND SERVER ROOM LOCATION: MMSU - MAIN LIBRARY, CITY OF BATAK, ILOCOS NORTE	SATURNINA F. NISPEROS DIRECTOR, INFORMATION TECHNOLOGY CENTER	GLASS PARTITION DETAILS	
PREPARED BY:	CHECKED/REVIEWED BY:	RECOMMENDING APPROVAL:	APPROVED BY:		
AIDA V. CABANG ARCHITECT IV	AIDA V. CABANG CHIEF - PHYSICAL PLANNING SECTION	ROMEO R. DULDULAO DIRECTOR, PFDG	SHIRLEY C. AGRUPIS UNIVERSITY PRESIDENT		